



Hair-GENTRON

— Hybrid —

COMPONENTS

COMPONENTS

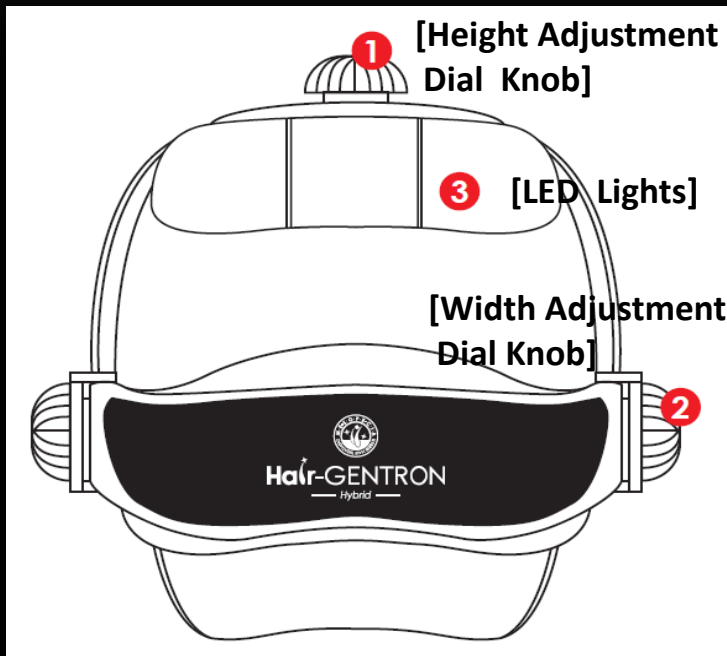

[Helmet]

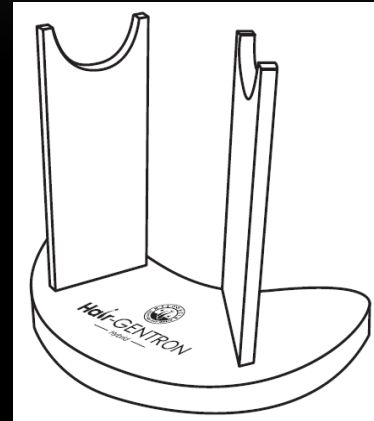

[Stand]

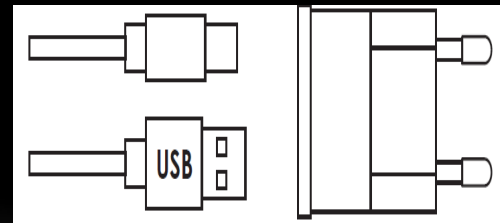

[USB-C Cable & Adapter]

COMPONENTS

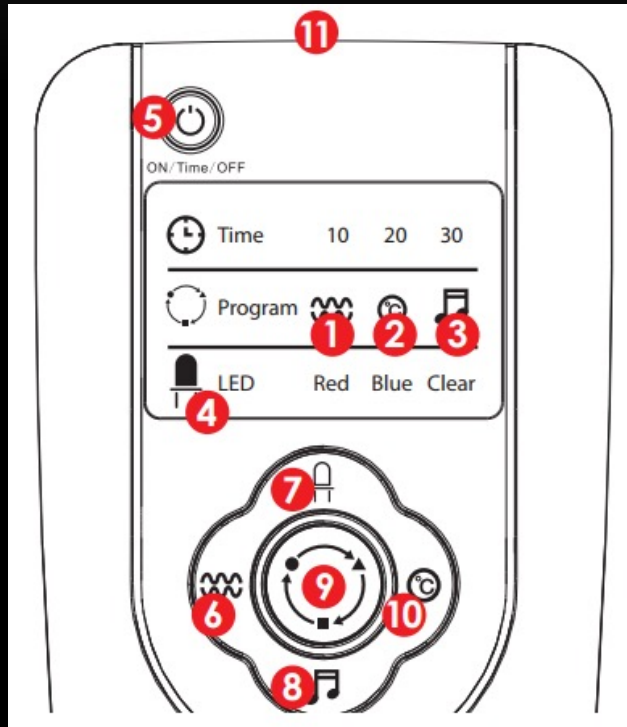

[Controller]

[Indicator]

- ① Air Pressure Massage Indicator
- ② Heating Indicator
- ③ Music Indicator
- ④ LED Indicator

[Operating Button]

- ⑤ Power on/off, Time Control
- ⑥ Air Pressure Massage on/off Button
- ⑦ LED Light Selection Button
- ⑧ Music Button
- ⑨ Air Pressure Massage Program Restart Button (restart with or without heat)
- ⑩ Heat on/off Button
- ⑪ USB-C Cable Connection Point

HAIR GENTRON

MECHANISM

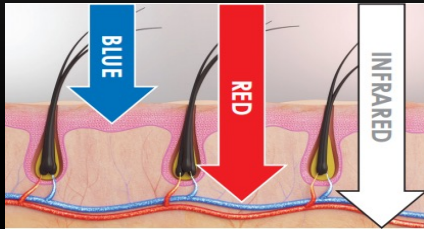

[LED]



[Massaging]



[Heating]

- The lights are absorbed by the mitochondria of the hair follicles, stimulating energy production in the hair cells, which in turn extends the hair's growth phase.



- ✓ Stimulate anagen re-entry in telogen hair follicles
- ✓ prolong duration of anagen phase
- ✓ Increase rates of proliferation in active anagen hair follicles
- ✓ Prevent premature catagen development

- Heating and massaging function improve blood flow in scalp.



- ✓ Provide nutrients to hair follicles

EFFECTS OF HAIR GENTRON



INFRA RED

- 840nm ·Penetrates into subcutaneous layer
- Promotes cell metabolism ·Improves blood circulation
- Increases energy

RED LIGHT

- 640nm · Penetrates into dermis
- Promotes cell metabolism ·Improves blood circulation
- Promotes nutrition supply to capillaries and strengthen hair strands

BLUE LIGHT

- 420nm ·Applies to epidermis ·Activates the keratin present in the hair shaft
- Promotes the alignment of the cuticles ·Increases water retention of hair
- Acts in the microbiological control
- Diminishes the sebaceous gland reducing the grease of the scalp

MASSAGING & HEATING

- Improves blood circulation
- Increase more nutrition and oxygen supply to hair follicles
- Relieves stress and tension

ADVANTAGES OF HAIR GENTRON



Non-invasive light therapy



Safe & painless therapy



Available for both professional
& home care



Infrared light, red light
and blue light can be
irradiated at the same time.



Proper distance from the
source of the light energy and
scalp is guaranteed which
leads to the optimal emission
effect.



Massaging function can be
done while lights are irradiated.



Music mode helps the user
feel relaxed.



Heating function can be added
during treatment

COMBINATION THERAPY

GENOSYS HR³ MATRIX MESOPECIA KIT + HAIR GENTRON

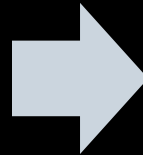

THANK YOU
